



***Quick Connect
Pull Rings***



***Faster To
The Finish!***



Modular Tubing Systems



As Easy As . . .

1. Open



2. Fit



3. Close



The newly developed combination joint and the extended profile allow the Quick Connect Pull Ring to be placed easily over the flanged tube ends. The clasp can be guided over the closing hook with sufficient play. The flanged ends can be connected to each other quickly - due to the strong and ergonomically shaped toggle-clip. The bolt on the swivel joint can be tightened later, if required, when the ring is closed. Dismantling is just as easy as assembling. The tubing and components can be changed in the blink of an eye.

The Best Of Both Worlds

Whatever your goal may be, the new Quick Connect Pull Ring from Jacob will get you there much faster. It combines the advantages of the well-known two-part, bolted pull ring and the quick release pull ring (patent pending).

New tooling and production processes were developed to launch this new generation of pull rings onto the market. They guarantee quality mass production of the individual components.

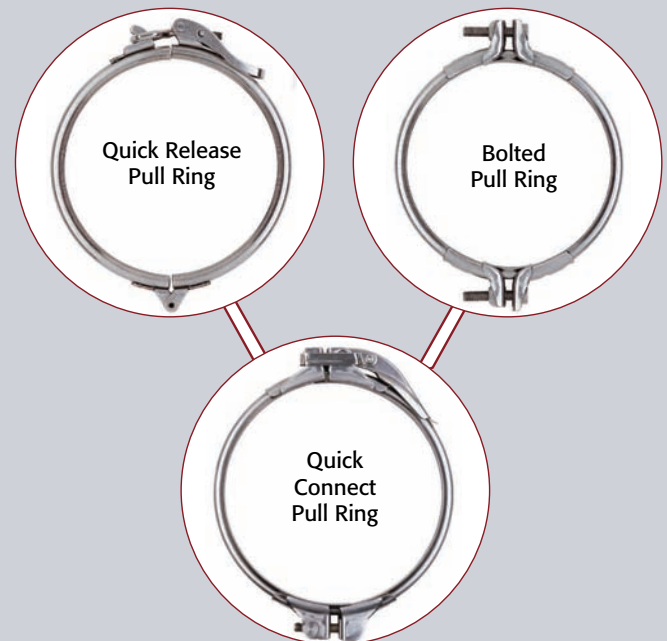

The Benefits. . .

Quicker Assembly

Your assembly times will drastically decrease with the new Quick Connect Pull Ring. The wide open profile noticeably simplifies installation with the "U"-shaped seal. The pull ring bolt is factory preset to positively engage with the tube flange, ensuring fast toggle-clip closure. If necessary, the bolt can be tightened further after installation to increase the connection strength and tightness.

Reduced Inventory

Reduce the size of your inventory with the new Quick Connect Pull Ring as it combines the advantages and functions of two existing types of pull rings. Its stability and sealing properties are as good as those of the two-part pull ring. Because the new pull ring can be easily adjusted, it can be fitted more quickly than the previous quick release pull ring. **One pull ring for all situations!**

Reduced Planning

Reduce the amount of planning with the universal Quick Connect Pull Ring. No need to choose between a quick-fit or airtight and stable solution. With the new pull ring, all tubing and parts are installed in the blink of an eye – with the excellent sealing properties and strength that you would expect from Jacob components. Dismantling is just as quick and easy, adding to its versatility.

One Pull Ring - Three Advantages



Fast

One snap – and the Quick Connect Pull Ring is in place. The solid and ergonomically shaped grip enables the toggle clip to be opened and closed firmly, with little effort. Time and time again.



Tight

Due to the overlapping ends of the ring and combined with the newly designed "U" shaped seal, the new Quick Connect Pull Ring provides an airtight connection.

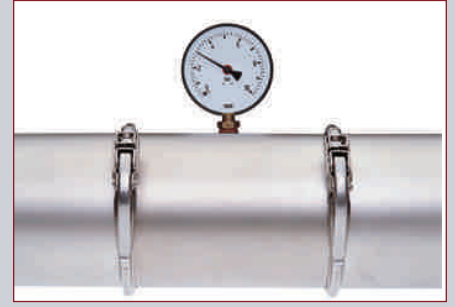

Secure

The strength of the new Quick Connect Pull Ring has been certified by the independent institute DMT. When tightened with a torque wrench to 10 Newton meter (Nm), it has an explosion pressure resistance of 3 bar.

Innovative Precision

Every detail has been considered to find the best possible combination of: speed - air tightness and - stability.



The Clasp

fast · tight · secure

Curved clasp, strong, ergonomic grip and overlapping on the ring ends.



The Joint

fast · tight · secure

Bolt preset at the factory, adjustable and compact design.



The Profile

fast · tight · secure

Extended profile, rounded ring ends and optimum connection with the newly designed "U" shaped seal.

An Unbeatable Combination With The Newly Designed "U" Shaped Seal.

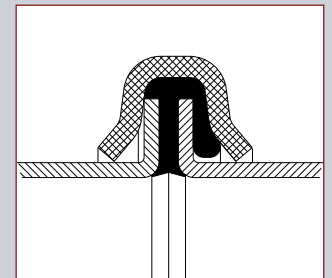
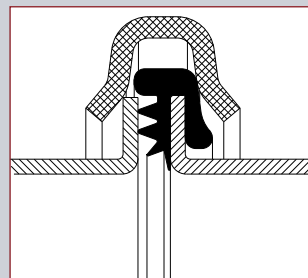
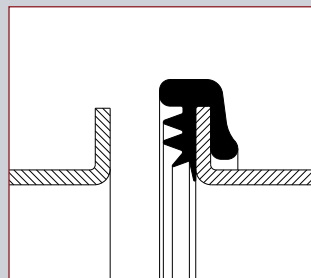
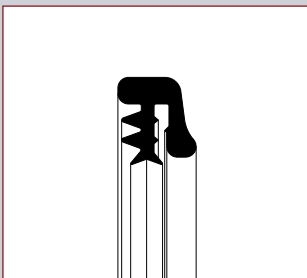

These "U" shaped seals were designed in conjunction with the development of the new generation of pull rings (patent pending).

The cross section of the new Quick Connect Pull Ring is tailored to fit wall thicknesses of 1 to 1.5 mm with the installation of a 1 mm "U" shaped seal. Wall thicknesses of 1.5 to 2 mm are installed using the 2 mm "U" shaped seal. This not only guarantees consistently high connection strength and air tightness, it also ensures the greatest possible ease of installation.

Quick Connect Pull Ring For 1 / 2 mm Tube Systems

Nominal Diameter Ø	Galvanized Item #	Stainless Steel Item #
80	12082903	12083903
100	12102903	12103903
120	12122903	12123903
140	12142903	12143903
150	12152903	12153903
175	12172903	12173903
200	12202903	12203903
224*	12222903*	12223903*
250*	12252903*	12253903*
300*	12302903*	12303903*

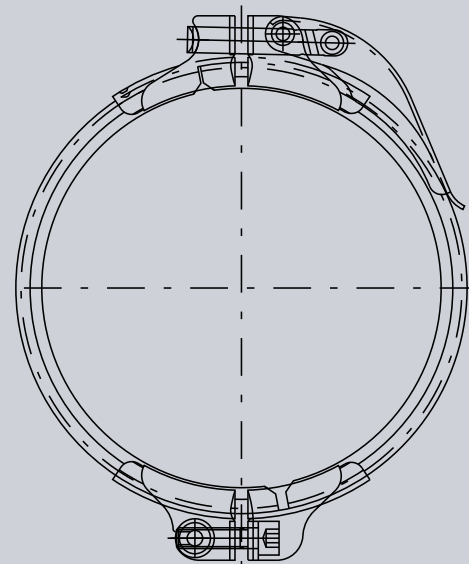

The new Quick Connect Pull Ring will immediately replace the previous Quick Connect Pull Ring in diameters 80 mm to 200 mm inclusive.

* Available after mid-year 2002.

U-Shaped Seals For 1 / 2 mm Tube Systems

Perbunan NBR Item #	Silicon SI Item #	Keltan EPDM (conductive) Item #	Viton FKM (FPM) Item #
10086951/2	10087951/2	100889515/25	10089951/2
10106951/2	10107951/2	101089515/25	10109951/2
10126951/2	10127951/2	101289515/25	10129951/2
10146951/2	10147951/2	101489515/25	10149951/2
10156951/2	10157951/2	101589515/25	10159951/2
10176951/2	10177951/2	101789515/25	10179951/2
10206951/2	10207951/2	102089515/25	10209951/2
10226951/2	10227951/2	102289515/25	10229951/2
10256951/2	10257951/2	102589515/25	10259951/2
10306951/2	10307951/2	103089515/25	10309951/2



Modular Tubing Systems

Jacob Tubing, L.P.
3948 Willow Lake Blvd. • Memphis, TN 38118
Mailing Address:
P.O. Box 754000 • Memphis, TN 38175
Phone: 901-566-1110 • Fax: 901-566-1910
www.jacob-tubing.com
e-mail: info@jacob-tubing.com